

LIFESTYLE PRODUCTS



GMS
REHABILITATION

SWEP Contract Equipment Catalogue



GMS

REHABILITATION

As a leading supplier of rehabilitation equipment within Victoria and throughout Australia, we offer an extensive range of products, assisting you with all your home health, mobility and rehabilitation requirements.

Approved supplier for:

NDIA

(National Disability Insurance Agency)
provider number: 84097534

SWEP

(Statewide Equipment Program)

TAC

(Transport Accident Commission)
for High End scripted Powered & Manual Wheelchairs
plus Repairs/Maintenance.

DVA

(Department of Veterans' Affairs)

VWA

(Worksafe Victoria)



CONTENTS

MOBILITY..... Page 4

Rollators/Wheeled walkers

Pacer Plus.....	Page 4
Mini Mack.....	Page 4
Mighty Mack.....	Page 4

WHEELCHAIRS..... Page 5

Manual Rigid wheelchairs

Wheelchairs (Adult) - TILITE TRA.....	Page 5
Wheelchairs (Paediatric) - TWIST.....	Page 6

SCOOTER..... Page 7

Mobility 4 wheel scooter

Shoprider 888SE explorer.....	Page 7
-------------------------------	--------

BEDROOM..... Page 8

Beds

Etude plus (Single bed).....	Page 8
ScanBeta (Paediatric).....	Page 9

Bed Accessories

Etude plus accessories.....	Page 8
-----------------------------	--------

Mattresses

Zenith (Paediatric).....	Page 10
Zenith (Single Mattress).....	Page 10
Zenith Mattresses (Various sizes).....	Page 11

Alternating mattress overlay system

PM265.....	Page 12
------------	---------

Full Mattress Replacement system

PM268.....	Page 13
------------	---------

PATIENT LIFTER SLINGS..... Page 14

Slings

General purpose slings.....	Page 14
-----------------------------	---------

ROLLATORS/WHEELED WALKERS



N.4206AE-DB



N.4206AE-RD



N.4205AD-DB



N.4216-RD

THE PACER PLUS - MINI, STANDARD & TALL

CODE		SEAT HEIGHT	SEAT WIDTH	SITTING SPACE	HANDLE HEIGHT	USER HEIGHT	S.W.L*
N.4206AG-RD	MINI	50cm	34.5cm	44cm	75-86cm	146-161cm	130kg
N.4206AE-DB	STD	55cm	34.5cm	44cm	80-91cm	151-170cm	130kg
N.4206AE-RD	STD	55cm	34.5cm	44cm	80-91cm	151-170cm	130kg
N.4206AH-RD	TALL	60cm	34.5cm	44cm	85-96cm	155-175cm	130kg

Excellent lightweight rollator is suitable for someone with limited mobility and requires a frame for support whilst walking. Versatile and manoeuvrable in and around the home. Designed with 19cm castor wheel for improved stability over uneven surfaces. Designed with a seat to rest, folds easily for transport and features a folding lockable backrest for smaller car boots. Available in Red and Dark Blue.

- Super lightweight aluminium frame 7.5kgs
- Folds easily for transport
- Locking break with ball & locking folding backrest
- Soft padded seat and bag

The Pacer plus complies with the requirements of ISO11199-2:2005

THE MINI MACK & THE MACK

CODE		SEAT HEIGHT	SEAT WIDTH	SITTING SPACE	HANDLE HEIGHT	USER HEIGHT	S.W.L*
N.4205AD-DB		49cm	43cm	51cm	75-85cm	147-163cm	150kg
N.4205V-DB		58cm	43cm	51cm	87-99cm	165-190cm	150kg

The Mini Mack is perfect for the larger shorter person, The Mack is perfect for the larger taller person. Comes standard with ball style locking brake, solid padded seat, front basket and a removable backrest for easy storage. Lightweight aluminum frame with arthritic hand grips, solid 7.6" 19cm castors and available in Dark blue.

- Folds easily for transport
- Overall weight 9.4kg

The Mini Mack and standard Mack complies with the requirements of ISO11199-2:2005

THE MIGHTY MACK

CODE		SEAT HEIGHT	SEAT WIDTH	SITTING SPACE	HANDLE HEIGHT	USER HEIGHT	S.W.L*
N.4216-RD		55cm	51cm	58cm	77-92cm	147-175cm	200kg

Specially designed heavy duty bariatric rollator provides excellent stability in a mobility frame as well as added security for those who require a solid padded seat and larger sitting area when it's time to rest. Comes standard with ball style locking brake, front basket and a removable backrest for easy storage. Arthritic hand grips, solid 7.6" 19cm castors and available in Red.

- Folds easily for transport Overall weight 9.4kg

The Mighty Mack complies with the requirements of ISO 11199-2:2005

MANUAL RIGID WHEELCHAIRS - ADULT



SD.TILITETRA

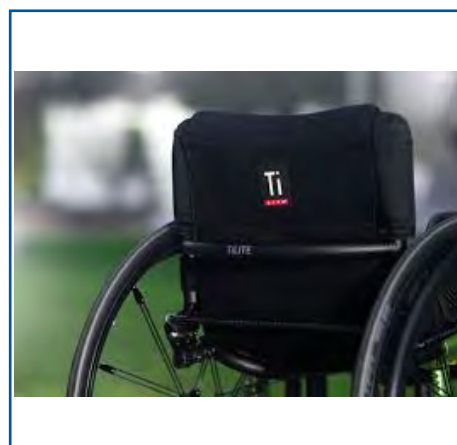
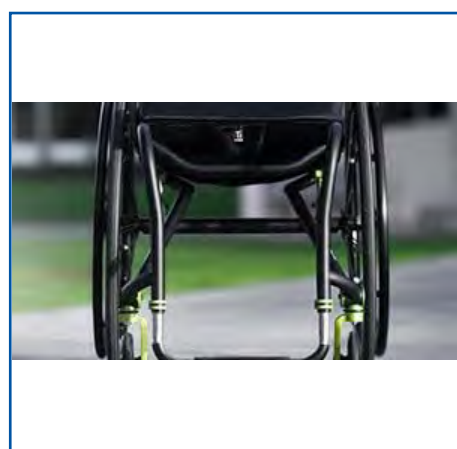

TiLITE TRA

CODE	SEAT WIDTH	SEAT DEPTH	SEAT HEIGHT	GROSS WEIGHT	S.W.L.*
SD.TILITETRA	30.5-51cm	30.5-51cm	38-53cm	5kg	158kg

Improved adjustability and rigidity combined with a modern sleek look this TiLite TRA wheelchair provides an even broader range of clinical solutions to the end user.

- Smart in its design, the TRA rigid dual frame provides an improved push stroke action. Enhanced lower frame design means no wasted energy and fewer strokes when propelling throughout the day.
- The Tru-Fit System opens up the world of adjustability by incorporating an infinite adjustment mechanism. The Tru-Fit system allows you to fine tune the fit of your chair because you are not limited to a series of pre-set holes. Also, instead of bolting through frame-weakening holes, components clamp directly onto the frame. This eliminates one of the main stress points on today's wheelchairs by reducing the number of holes in the frame.
- Adjustable camber mount incorporates TiLite's Tru-Fit system with up to 3.5" of rear seat height adjustment.
- Patented speedloader adjustable front caster housing quickly and accurately adjusts fork angle in 1" increments.
- Zero play camber plugs give a much tighter feel to the chair like sport suspension in a car. CNC machined from billet aluminum to the highest tolerances, they remove any side to side movement from the rear wheels.
- TiShaft back release bar makes folding and unfolding the backrest easy from any angle.

TECHNICAL SPECIFICATIONS

Frame Features:

Frame Options:

Transport Weight:

User Weight:

Total Chair Width:

Seat Width:

Front Seat Width:

Seat Depth:

Front Seat Height:

Rear Seat Height:

Camber:

Front Frame Angle:

Footrest Width Options:

Center of Gravity Adj:

Front Wheels:

Rear Wheels:

Handrims:

Convenience:

Aesthetics:

Titanium Dual-Tube Rigid, TiFit, Full Adjustability

Black Edition, SuperLite Edition, Heavy Duty Frame, Power Adaptable Frame, Reinforced Frame

*5kg,

158kg (Safe working load - S.W.L)

23" (58.4cm)

12" - 20" (30.5cm - 51cm)

(Seat Taper) 3 Options

12" - 20" (30.5cm - 51cm)

15" - 21" (38cm - 53cm)

13" - 21" (33cm - 53cm)

0°, 2°, 4°, 6°, 8°, or 12°

70°, 80°, 85°, or 90°

Standard Taper or V-Front End

5" (12.5cm)

23 Options

67 Options

15 Options

Folding Angle Adjustable Seat Back

6 Titanium Frame Finishes

16 Frame Colors

6 Color Anodize Packages

7 Ultrasuede Colors

8 Spinergy Wheel Colors

Warranty Lifetime on Frame & One Year on TiLite Components

**Weights / widths based on 16" x 16" (40.5cm x 40.5cm) chair, 0° camber, minimum rear wheel spacing and standard features. Rear wheels not included in transport weight. For reference, two standard 24" (540) rear wheels weigh 7.2 lb. (3.3kg).*



TIFIT. PERSONAL ERGONOMICS - The difference between a TiFit® chair and all other chairs is that a TiFit chair is a wheeled prosthetic: Every frame is made to measure. The optimized fit of a TiFit chair brings unparalleled performance and function. You will feel the difference in everything you do.

MANUAL RIGID WHEELCHAIRS - PAEDIATRIC



TiLITE TWIST

CODE	SEAT WIDTH	SEAT DEPTH	SEAT HEIGHT	GROSS WEIGHT	S.W.L.*
SD.TILITETWIST	20-38cm	20-40.5cm	33-54.5cm	5.4kg	74.8kg



Designed from the ground up for kids, the Twist encourages exploration, independence, and, yes, playfulness. The TiLite Twist wheelchair provides an even broader range of clinical solutions to the end user with no parts or growth kits required to buy. Instead, the Twist grows with you.

- No growth kits required- Growth. Built in. Other chairs say they grow, but new parts or growth kits are required. With the Twist, growth is built in. Sized from 8" x 8"(20cm x 20cm) up to 15" x 16"(38cm x 40.5cm), the Twist offers 2"(5.1cm) of growth in seat width and 3"(7.6cm) of growth in seat depth.
- The 1" aluminum frame design makes for easy installation of seating components.
- Center Mount Anti-Tip with Single Swivel Caster allows for skills acquisition without compromising safety.
- High-Mount Footplate System
Maximizes Seat To Footrest Height STFH - as small as 6 inches of STFH
No need for risers and No clamp on systems.

TECHNICAL SPECIFICATIONS.

Frame Features:	Aluminum Mono-Tube Rigid, Growable, Full Adjustability
Frame Options:	Abduction Frame
Transport Weight:	5.4kg
Weight Limit:	74.8kg
Total Chair Width:	19" (48.3cm)
Seat Width:	8" - 15"(20cm - 38cm) 2" (5.1cm) Built-in seat width adj
Seat Depth:	8" - 16"(20cm - 40.5cm) 3" (7.6cm) Built-in seat depth adj.
Front Seat Height:	13" - 21.5" (33cm - 54.5cm) up to 2.25" (5.7cm) of built-in front seat height adj.
Rear Seat Height:	12" - 19.5" (30.5cm - 49.5cm) Built-in rear seat height adj. up to 3.5" (8.9cm)
Camber:	0°, 2°, 4°, 6°, 8°, or 12°
Front Frame Angle:	70°, 80°, or 90°
Center of Gravity Adj:	6" (15.2cm)
Front Wheels:	23 Options
Rear Wheels:	35 Options
Handrims:	15 Options
Convenience:	Transit Tie-Down Option, Folding Angle Adjustable Seat Back
Aesthetics:	16 Frame Colors 6 Color Anodize Packages 7 Ultrasuede Colors 8 Spinergy Wheel Colors

Warranty Lifetime on Frame and One Year on TiLite Components

*Weights / widths based on 12" x 12" (30.5cm x 30.5cm) chair, 0° camber, minimum rear wheel spacing and standard features. Rear wheels not included in transport weight. For reference, two standard 22" (501) rear wheels weigh 7 lb. (3.2kg).



TIFIT. PERSONAL ERGONOMICS - *The difference between a TiFit® chair and all other chairs is that a TiFit chair is a wheeled prosthetic: Every frame is made to measure. The optimized fit of a TiFit chair brings unparalleled performance and function. You will feel the difference in everything you do.*

CUSTOM CONFIGURATION - *Custom Configuration allows you to add options and components to your chair to meet your needs and to optimize your riding experience. This includes choices of wheels, handrims, tires, wheel locks, color, tattoos, and more. TiLite offers more options than any other manufacturer!*

MOBILITY SCOOTER



SHOPRIDER 888SE EXPLORER

CODE	LENGTH	WIDTH	HEIGHT	RANGE/km	GROSS WEIGHT	S.W.L.*
SH.888SE	128cm	60cm	107cm	up to 40km	76kg	136kg

The Shoprider 888SE Medium compact size scooter provides ample features that you would only find in one of the larger model scooters. Equipped with large batteries and has features like 26cm tyres for safety and for the smooth ride, fully rotating lockable seat for the ease of transferring on and off the scooter, adjustable steering tiler and fold up armrests. Other reliable features include its rear wheel drive and electromagnetic brake which enhances its impressive safety and style all at the same time.

- Front and rear suspension
- High back Seat
- Adjustable Steering Tiler
- Adjustable Width armrests
- Fold up and down armrests
- Sliding rotating seats
- Front shopping basket
- Variable seat height
- Horn
- Battery level warning light
- Front and rear bumper pads
- Anti tips wheels
- Front lights
- Turning Radius of 150cm
- Batteries 2 x 50 AMP

TECHNICAL SPECIFICATIONS

Length:	128cm
Width:	60cm
Height:	107cm
*Safe Climbing Angle:	9°
*Max Climbing Angle:	9°
Maximum Load:	Single User* 136Kgs
Charger:	4 Amp
Motor Size:	0.75Hp
Maximum Speed:	8Kph
Battery Capacity:	2 x 50 amp (Minimum amp)
Maximum Range:	up to 40km
Wheel Size:	26cm
Turning Radius:	150cm
Gross Weight:	76kg (Without batteries)

Comprehensive warranty

BEDS

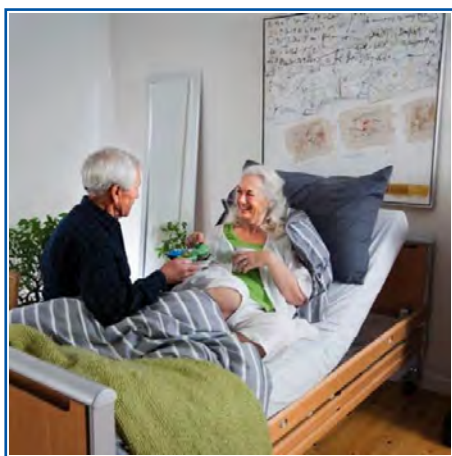
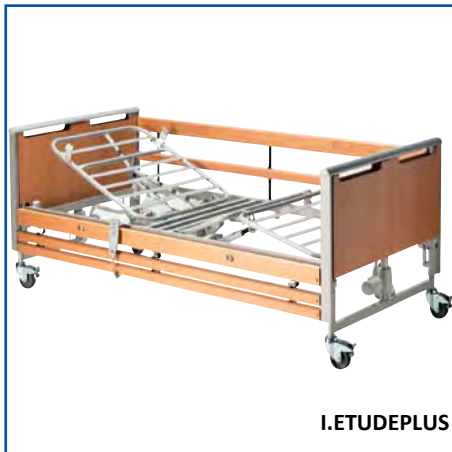

ETUDE PLUS

CODE	LENGTH (INT./EXT.)	WIDTH (INT./EXT.)	MIN/MAX HEIGHT	UNDER BED CLEARANCE	S.W.L*
I.ETUDEPLUS	207/219cm	90/102cm	33-73cm	19cm	180kg

The Etude Plus bed is leading the way with comfort, ease of use and its advanced features. Designed to assist caregivers workload with 4 function hi-low, headrest raise, knee break raise, trendelenberg and reverse trendelenberg. The backrest auto-regression mechanism swings up and back as the bed profiles at desired angle for comfort and reducing the propensity for the client to slide down the bed. This reduction in shear and friction forces that can assist in the prevention of skin damage and associated pressure ulcer formation. Britt V Full Length Side Rails have been designed with an easy to use release mechanism for lowering, no tools required to mount or remove.

This etude plus bed with electrically operated backrest offers ample functionality including:

- Electric hi-low bed height adjustment
- Electric backrest and knee break
- 4 rotating lockable casters with toe brake
- Personal hand control (options – with or without lockable hand control)
- High quality electronics
- Powder coated frame with stylish wooden panel design
- Easy Maintenance and handling, portable and great for storage
- Tool free construction by one person
- Linak motor - IPX6

SPECIFICATIONS

- 207/219cm(L) x 90/102cm(W) Single bed
- Sleeping surface width: 90cm
- Width overall: 102cm
- Sleeping surface length: 200cm
- Length overall: 219cm
- Maximum height: 73cm
- Minimum height: 33cm
- Height Adjustable ranges: (etude plus bed) 40– 80cm
- Head Raise: 0° to 70°
- Knee/leg raise: 0° to 25°
- Knee break: 0° to 18°
- Trendelenberg/tilt: 11°
- 3 year framework warranty
- 2 year actuators warranty
- Safe working loads of 180kg

ETUDE PLUS ACCESSORIES

CODE	
I.1538458-0101	Etude Britt V Full length side rails (Beech pair)
I.1522787-0125	Line Full length extendable rails with 20cm extension
I.1542093-0154	Etude Lifting pole - Gooseneck
I.ETP-B-S-3	Straight 59cm high Bed stick with single clamp & Top ball end
I.ETP-B-S-H-3	Hooked 59cm high Bed stick with Single clamp & Top ball end
DU.ETUDEPLUS-SRC	Padded covers for Britt V Full length side rails (waterproof)
I.1548936-7035	HL84 Lockable 4 function handset for SAEAS homes
I.1423994-0154	20 cm Extension (makes mattress surface 225cm long)

Note: Use DU.PCMA009 - Long Mattress with I.1423994-0154- 20cm Extension base.

BEDS

I.SCANBETAMEDIUM



SCANBETA 40CM LOWERING SIDE RAILS



SCANBETA 80CM FOLDING
PANELS-OPEN TO 180°



SCANBETA 40CM
PANELS-OPENS TO 180°

SCANBETA - PAEDIATRIC

CODE	LENGTH INT./EXT.	WIDTH INT./EXT.	MIN/MAX HEIGHT	S.W.L.*
I.SCANBETA MEDIUM	162/168cm	72/78cm	30 to 90cm	100kg
I.SCANBETA LARGE	182/188cm	82/88cm	30 to 90cm	100kg

The ScanBeta paediatric beds have been designed to grow with the child, and made to enable high levels of configurability.

Invacare ScanBeta paediatric beds are available in three sizes and are perfect for children aged from 3 to 12 years old however, GMS has just the two sizes available under the SWEP contract, which is Medium designed for 6-9yrs and Large designed for 9-12yrs. The ScanBeta NG conforms to the very highest of safety standards. The ScanBeta has no distances above 6cm on the sides or at the mattress support. Both the functionality of the mattress platform and the sides can be configured to meet individual requirements and can be upgraded or downgraded at a later stage, in line with a user's changing needs.

- Safety Built-in (Tested to Nordic Requirement Specifications).
- Available in mattress platform sizes of:
70cm(W) x 160cm(L)- MEDIUM (for average body size from 6-9yrs)
80cm(W) x 180cm(L)- LARGE (for average body size from 9-12yrs)
- Ergonomic, Safe & Comfortable - **Adjustable height**, Locable handset as standard, four locable castors and height can be configured with 80cm sides.

SPECIFICATIONS

- Sleeping surface width: 72cm (Medium) & 82cm (Large)
- Width overall: 78cm (Medium) & 88cm (Large)
- Sleeping surface length: 162cm (Medium) & 182cm (Large)
- Length overall: 168cm (Medium) & 188cm (Large)
- Maximum height: 90cm
- Minimum height: 30cm
- Height Adjustable ranges: (scanbeta bed) 30cm – 90cm
- Backrest/Head Raise: 0° to 73°
- Knee/leg raise angle: 0° to 24° (Medium) & 0° to 26° (Large)
- Knee break/thigh angle: 0° to 31° (Medium) & 0° to 27° (Large)
- 3 year framework warranty
- 2 year actuators warranty
- Safe working loads of 100kg

Options and variety of configurations:

- **ScanBeta bed configured with 40cm (Height) lowering side rails (2 styles).**
 1. Vertical rail bars, attractive beech finish, double-catch release mechanism for increased safety.
 2. Clear perspex panel drop rails, double-catch release mechanism for increased safety.
 - **ScanBeta bed configured with 80cm(Height) folding panels-opening to 180°**
Vertical rail bars, attractive beech finish, panels open to 180° minimising space requirements.
 - **ScanBeta bed configured with 40cm (Height) panels-opening to 180°**
Vertical rail bars, attractive beech finish, panels open to 180° and secure locking mechanism with catch release for increased safety.
- Other options include:** Support handle (U-shaped clamp on grip handle), Self help pole with gooseneck handle (clamps onto bed) and Child safety locking mechanism (2 catch opening).

MATTRESSES



DU.PCMA-P1



DU.PCMA009



**3 LAYERED PRESSURE REDUCING
MEMORY FOAM MATTRESS**

ZENITH MATTRESS - PAEDIATRIC (TO SUIT SCANBETA BED)

CODE	LENGTH	WIDTH	HEIGHT	MAT. SIZE	S.W.L.*
DU.PCMA-P1	160cm	74cm	15cm	Medium	25-80kg
DU.PCMA-P2	180cm	84cm	15cm	Large	25-80kg

Note: Zenith paediatric mattress DU.PCMA-P1 designed to suit the Scanbeta bed medium and DU.PCMA-P2 designed to suit Scanbeta bed large.

The Zenith foam mattresses provide a comfortable, stable sleeping environment, whilst minimising peak pressure points, allowing for immersion into the foams, and therefore increasing the surface area available for pressure redistribution.

Features:

- 3 layered pressure reducing memory form mattress
- Side panels for secure transfer on/off
- PUPPS compliant mattresses
- Hospital grade Dunlop foams
- Anti-shear 2 way stretch cover (vapour permeable, waterproof & fire retardant).
- Mattresses are fully welded for infection control purposes.

ZENITH MATTRESS-SINGLE (TO SUIT ETUDE PLUS BED)

CODE	LENGTH	WIDTH	HEIGHT	MAT. SIZE	S.W.L.*
DU.PCMA009	205cm	90cm	15cm	Single custom	40-150kg

Note: Zenith mattress DU.PCMA009 designed to suit Etude plus bed. DU.PCMA009 mattress meets entrapment guidelines.

The Zenith foam mattresses provide a comfortable, stable sleeping environment, whilst minimising peak pressure points, allowing for immersion into the foams, and therefore increasing the surface area available for pressure redistribution.

Features:

- 3 layered pressure reducing memory form mattress
- Hinged sides for head raise & knee break
- Side panels for secure transfer on/off
- PUPPS compliant mattresses
- Hospital grade Dunlop foams
- Anti-shear 2 way stretch cover, (vapour permeable, waterproof & fire retardant).
- Mattresses are fully welded for infection control purposes.

Important note: All mattresses and overlays must have more than 22cm between top of the uncompressed mattress and top of rail, and less than 6cm gap to headboard, foot panel or siderail. An entrapment risk assessment should be conducted with reference to the individual's neck/head and chest sizing.

ZENITH MATTRESS-LONG (TO SUIT ETUDE PLUS BED WITH 20CM EXT.)

CODE	LENGTH	WIDTH	HEIGHT	MAT. SIZE	S.W.L.*
DU.PCMA009-LONG	225cm	90cm	15cm	Single long	40-150kg

Note: Zenith mattress DU.PCMA009-LONG designed to suit Etude plus bed with I.1423994-0154 Etude plus 20cm bed extension. DU.PCMA009-LONG mattress meets entrapment guidelines.

MATTRESSES



DU.PCMA001



MEMORY FOAM.



DU.PCMA002



DU.PCMA007

ZENITH MATTRESS-SINGLE

CODE	LENGTH	WIDTH	HEIGHT	MAT.SIZE	S.W.L.*
DU.PCMA001	193cm	90cm	15cm	Single	40-150kg

Note: Zenith mattress DU.PCMA001 designed to use with non tender bed (re-issue) with single bed base.

The Zenith foam mattresses provide a comfortable, stable sleeping environment, whilst minimising peak pressure points, allowing for immersion into the foams, and therefore increasing the surface area available for pressure redistribution.

Features:

- 3 layered pressure reducing memory form mattress
- Hinged sides for head raise & knee break
- Side panels for secure transfer on/off
- PUPPS compliant mattresses
- Hospital grade Dunlop foams
- Anti-shear 2 way stretch cover, (vapour permeable, waterproof & fire retardant).
- Mattresses are fully welded for infection control purposes.

ZENITH MATTRESS- SINGLE

CODE	LENGTH	WIDTH	HEIGHT	MAT.SIZE	S.W.L.*
DU.PCMA002	198cm	90cm	15cm	Single shorter	40-150kg

Note: Zenith mattress DU.PCMA002 designed to use with non tender bed (re-issue) with shorter single bed base.

ZENITH MATTRESS-3/4 BED

CODE	LENGTH	WIDTH	HEIGHT	MAT.SIZE	S.W.L.*
DU.PCMA003	193cm	107cm	15cm	3/4 bed	40-150kg

Note: Zenith mattress DU.PCMA003 designed to use with non tender bed (re-issue) with 3/4 bed base.

ZENITH MATTRESS-KING SINGLE

CODE	LENGTH	WIDTH	HEIGHT	MAT. SIZE	S.W.L.*
DU.PCMA004-L	203cm	107cm	15cm	King single	40-150kg

Note: Zenith king single mattress DU.PCMA004-L designed to use with non tender bed (re-issue) with king single bed base.

ZENITH MATTRESS-SAFETY SIDES

CODE	LENGTH	WIDTH	HEIGHT	MAT. SIZE	S.W.L.*
DU.PCMA014	205cm	90cm	24/15cm	Single	150kg

Note: Zenith safety sides mattress DU.PCMA014 designed to suit Etude plus bed. DU.PCMA014 mattress meets entrapment guidelines.

ZENITH MATTRESS-OVERLAY BASE MATTRESS (TO SUIT PM265)

CODE	LENGTH	WIDTH	HEIGHT	MAT. SIZE	S.W.L.*
DU.PCMA007	200cm	90cm	7.5cm	Single custom	150kg

Note: Zenith mattress DU.PCMA007 designed to suit Alternating mattress overlay bed base. Use under AX.PM265 overlay with or without side rails.

ALTERNATING MATTRESS SYSTEM



PM265 MATTRESS OVERLAY SYSTEM

CODE	LENGTH	WIDTH	HEIGHT	MATTRESS SIZE	S.W.L*
AX.PM265	200cm	90cm	12.7cm	Single	160kg

The PM265 Alternating Overlay System assists in both prevention and healing of stage 1 & 2 pressure injuries or for clients at low to medium risk.

The PM265 Alternating Overlay System is a high quality pressure redistribution surface suitable for clients with medium risk of Pressure Injury. Designed to fit onto a single bed (mattress overlay) this product is easy to install with basic instructions printed on the pump unit. Effective pressure redistribution is achieved by the alternation of the main body cells in a cycle of 9.6 minutes.

The elegant pump unit has a soft touch panel that is modern and simple to use. Features of the pump unit include 10 comfort level adjustments, incremented in weight levels for a range of client's needs. Static mode with auto revert after 20 minutes, low pressure alarm indicated by an audible sound and visual LED indicator. Smart pressure detection technology starts and stops the pump as required, therefore increasing the pump life expectancy, and reducing noise. Multi therapy modes assist carers and therapists in providing appropriate pressure care and improving client compliance. The lock out feature ensures peace of mind once unit is correctly set to individual needs. A power failure alarm and service alarm alert users or carers of the need for urgent action.

The mattress overlay incorporates 17 cells, with the top 3 cells providing a non alternating pillow section. The remaining 14 cells have a combination of ventilated and non ventilated cells. The ventilated cells allow for low air loss circulation assisting in reducing perspiration and increasing client comfort. The fully enclosed zippered cover is stretchable, vapour permeable, waterproof, antimicrobial with welded seams consistent with Australian infection control guidelines.

The PM265 Alternating Overlay System has been designed to assist with client safety, including a clearly indicated head and foot end, CPR release valves and alarms.

FULL MATTRESS REPLACEMENT SYSTEM



PM268 FULL MATTRESS REPLACEMENT SYSTEM

CODE	LENGTH	WIDTH	HEIGHT	MAT.SIZE	*S.W.L
AX.PM268	200cm	90cm	20cm	Single	180kg

The PM268 Full Mattress Replacement System assists in both prevention and healing of stage 1 & 2 pressure injuries or for clients at low to medium risk.

The PM268 Full Mattress Replacement System is a high quality pressure redistribution surface suitable for clients with medium to high risk of Pressure Injury. The combination of specially designed cells incorporated with a low pressure high flow pumping system, enables maximum pressure redistribution.

The stylish pump unit has a soft touch panel and is modern and simple to use. Features of the pump unit include 10 comfort level adjustments, incremented in weight levels for a range of client needs. Static mode with auto revert after 20 minutes, low pressure alarm indicated by an audible sound and visual LED indicator. Smart pressure detection technology starts and stops the pump as required, therefore increasing the pump life expectancy, and reducing noise. Multi therapy modes assist carers and therapists in providing appropriate pressure care and improve client compliance. The lock out feature ensures peace of mind once the unit is correctly set to individual needs. A power failure alarm and service alarm alert users or carers of the need for urgent action.

The full mattress replacement system incorporates 20 cells, with the top 3 cells providing a non alternating pillow section. The remaining cells have a combination of ventilated and non ventilated cells and have cell in cell technology, to provide additional protection for clients in case of power failure. The inner cells provide a nominal support when the pump is unable to supply air pressure due to prolonged times of power failure. The ventilated cells allow for low air loss circulation assisting in reducing perspiration and increasing client comfort. The fully enclosed zippered cover is stretchable, vapour permeable, waterproof, antimicrobial with welded seams consistent with Australian infection control guidelines.

The PM268 Full Mattress Replacement System has been designed to assist with client safety, including a clearly indicated head and foot end, CPR release valves and alarms.

PATIENT LIFTER SLINGS

I.17041

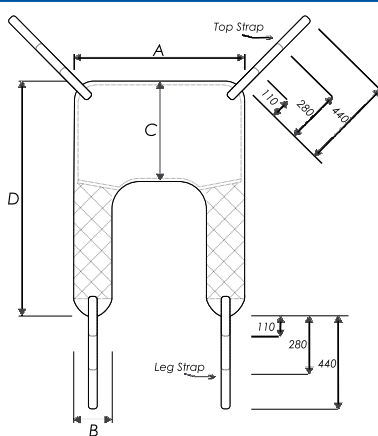

I.17067

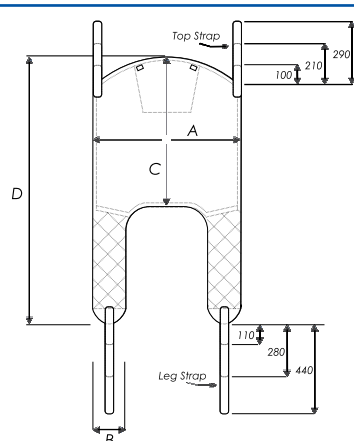

GENERAL PURPOSE SLING

CODE	FABRIC	MESH	SIZE	S.W.L*
I.17105		I.17123	SMALL	205kg
I.17041		I.17124	MEDIUM	205kg
I.17043		I.17125	LARGE	205kg
I.17204		N/A	XLARGE	205kg

Invacare Slings are designed to be simple and safe to use for both home and institutional patient lifting. The slings are manufactured from polyester fabric or mesh (suitable for bathing) with internal padding in pressure areas and utilises webbing attachment loops or keyhole buckles. The sling attachment straps are colour coded for sizing to allow easy sling selection and identification.

To be used by a qualified carer in conjunction with an appropriate Invacare patient lifting device to support patients with disabilities. Patients must be within the capacity indicated on the sling. The carer must adhere to the usage guidelines identified in the relevant slings instruction manual. All slings come with a one year limited warranty.

General Purpose Sling is available in four sizes in a choice of fabric or mesh. The sling provides easy fitting and good support for patients with some upper body control.

Recommended for general lifting.

Colour: Navy

	S	M	L	XL
A	820	920	1110	1270
B	230	220	260	260
C *	490	530	650	730
D	1180	1240	1360	1520
Code:	Fabric I.17105	I.17041	I.17043	I.17204
	Mesh I.17123	I.17124	I.17125	N/A

* Measurement is in millimeters - mm

GENERAL PURPOSE SLING WITH HEAD SUPPORT

CODE	FABRIC	MESH	SIZE	S.W.L*
I.17209		N/A	XSMALL	205kg
I.17247		I.17126	SMALL	205kg
I.17067		I.17127	MEDIUM	205kg
I.17069		I.17128	LARGE	205kg
I.17205		I.17248	XLARGE	205kg
N/A		I.17212	XXLARGE	205kg

This general purpose sling is to be used in conjunction with an appropriate Invacare patient lifting device to support clients with mobility disabilities and transferring difficulties. This sling provides easy fitting and good support for patients with some upper body control. The general purpose sling has been designed to be simple and safe to use for patients lifting whether it be at home or in an aged care/nursing facilities. This sling is manufactured from polyester fabric or mesh (suitable for bathing) with internal padding in pressure areas and utilises webbing attachment loop straps or keyhole buckles. The straps are colour coded for sizing to allow easy sling selection and identification and individual client management.

General Purpose Sling with Head Support is available in six sizes in a choice of fabric or mesh. The sling fits easily to a patient in bed or a chair, providing excellent upper body and head support.

Recommended for lifting from the floor and general lifting of the less secure patient.

Colour: Navy

	XS	S	M	L	XL	XXL
A *	820	830	970	1140	1310	1420
B	190	230	230	250	260	270
C	760	790	920	990	1000	1060
D	1290	1330	1450	1680	1720	1850
Code:	Fabric I.17209	I.17247	I.17067	I.17069	I.17205	N/A
	Mesh N/A	I.17126	I.17127	I.17128	I.17248	I.17212

* Measurement is in millimeters - mm

ADDITIONAL SERVICES



FREE - ASSESSMENT SUPPORT SERVICE

GMS offers a Specialist Equipment Assessment Team (S.E.A.T) service which provides solutions to Therapists and complex clients at assessment time in Powered and Manual wheelchairs, Pressure relief & Seating equipment ranges.



EQUIPMENT HIRE

GMS Rehabilitation is a leading supplier of hire equipment for both hospital and private clients. The GMS hire pool consists of products such as wheelchairs (both manual and powered), walkers, scooters, bathroom and toilet equipment, seating, beds, pressure care, lifting hoists and bariatric equipment. A separate Hire Brochure is available, please call for a copy.

REPAIRS & SERVICING

Full workshop service available at all of our stores.

- Mobile technicians that can come to you.
- Tag and testing.
- Service Contracts.
- Powered Mobility equipment, regular servicing and battery testing.
- Specialising in pressure care repairs for mattress overlays, full mattress replacement systems. Including preventative servicing.

HOME MODIFICATIONS

Our Home Modification service provides modification work for improved access and safety for persons with limited abilities to live independently in their home and in the community.

An occupational therapist can assist you with recommendations for minor and major home modifications.

- Supply and installation of grab rails/hand rails.
- Supply and installation of banister rails.
- Supply and installation of hand held showers, lever taps, shower curtains and non slip surfacing.
- Access modifications such as ramps, step wedges and door widening.

ADDITIONAL SERVICES

Additional services and resources available to therapists and the Public include:

- Assessment/Training rooms available at Geelong and Lynbrook sites.
- Continuously Professional Development ((CPD) Education and Training workshops.
- Delivery service with complete set up in the home.
- Comprehensive range of products on view in all stores.

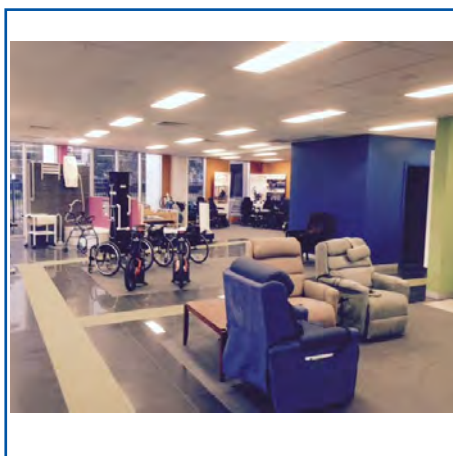

GMS

REHABILITATION

Gippsland

29 Princes Hwy, Traralgon Vic 3844

Melbourne

48 Commercial Dve, Lynbrook Vic 3975

Geelong

403 Moorabool Street, Geelong Vic 3220

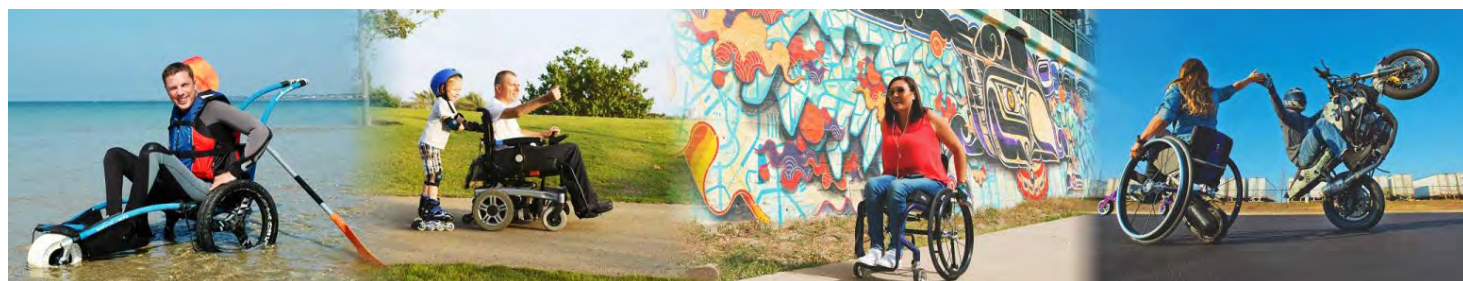

PH: 1300 734 223

FAX: 1300 734 553

EMAIL: sales@gmsrehab.com.au

www.gmsrehab.com.au

